



4765 W. Junction St.
Springfield, Missouri 65802

P (417) 864-5100

F (417) 864-0871

Terracon.com

October 24, 2023

Everton R-III School District
509 E. School Street
Everton, Missouri 65646

Attn: Will Darter, Superintendent
P: 417.569.8627
E: wdarter@evertontigers.org

Re: Lead in Drinking Water Sample Collection Report
509 E. School Street
Everton R-III School District
Terracon Project: B5237060

Dear Mr. Darter:

Terracon Consultants, Inc. (Terracon) is pleased to present the results of the drinking water testing at the above-referenced locations to the Everton R-III School District. As requested, Terracon completed first draw sampling of designated drinking water sources located within multiple facilities. The samples were submitted under chain of custody protocol to Pace Analytical, Inc., a Missouri Department of Natural Resources (MDNR) and a National Environmental Laboratory Accreditation Program (NELAP) accredited laboratory in Peoria, Illinois. The samples were analyzed for lead (Pb) in accordance with EPA Method 200.8, revision 5.4: *"Determination of Trace Elements in Waters and Wastes by Inductively Couple Plasma-Mass Spectrometry."*

Lead was identified at or above the State of Missouri's threshold of 5 parts per billion (ppb) in drinking water at the following facilities:

- High School Hallway; and,
- Agriculture Building.

Recommendations

The State of Missouri requires that sources of drinking water that are found to contain lead above the regulatory limit of 5 ppb be reduced to less than 5 ppb. Depending on the source of the lead (fixture, fitting, solder, piping, or original water source), schools districts have multiple options to address the lead. Terracon recommends to following based on the findings:

Explore with us

- All samples with a value above 5 ppb should be re-sampled with a flush (2nd draw) sample to determine the actual lead source (could be pipe system or solder beyond the actual faucet);
- Elementary schools, day care facilities, early learning centers, kindergarten and pre-kindergarten are the highest priority. Temporary solutions in these facilities should be minimized and the lead should be remediated as soon as possible. If it is determined that remediation cannot happen in the immediate future, take the faucets out of service, or replace them;
- Any faucet above 5 ppb, should have a “Not for Drinking” or “Not for Cooking” sign posted until the lead problem is resolved. As an alternative, each faucet which tested above 5 ppb can be flushed each morning prior to use. **These are very temporary, short-term solutions, and the source of the lead should be remediated as soon as possible;** and
- Notify staff and parents about the results and post testing results and remediation plans on the school’s website.



The following are the permanent solutions to reducing lead to below 5 ppb that must in place before August 1, 2024, or the first day on which students will be present in the building, whichever is later:

- 
- Any faucet above 5 ppb, not used regularly should be shut off and/or disconnected from use;
 - Any faucet above 5 ppb, used for or potentially used for ingestion should be shut off and/or disconnected from use until the lead problem is resolved;
 - Install filters at each faucet which dispenses drinkable water with lead above 5 ppb or at each point the water supply enters the building;
 - Provide purified water at each faucet which dispenses drinkable water with lead above 5 ppb; and
 - Replacement of pipe, solder, fitting, or fixture with lead-free components

Terracon also recommends applying the solutions provided in the US Environmental Protection Agency (EPA) “3T’s for Reducing Lead in Drinking Water in Schools and Child Care Facilities: A Training, Testing, and Taking Action Approach” manual.

Attached to this cover letter are your Sample Results and Recommendations, Laboratory Results, Faucet Sample Location Maps, Missouri Revised Statutes – 160.077 and the EPA’s 3Ts for Reducing Lead in Drinking Water in Schools and Child Care Facilities. The reports and guidance documents should be read in their entirety for a better

understanding of the regulations, requirements and procedures involved in reducing lead in drinking water. The 3Ts provides guidance on the entire process including remediation options and notification to staff and parents.

Terracon appreciates the opportunity to provide this service to the Everton R-III School District. If you have any questions regarding this report, please contact the undersigned at 417.720.7449.

Sincerely,
Terracon Consultants, Inc.



Mandy Carlson
Assistant Scientist



Mitch Reiber, C.I.H.
Senior Industrial Hygiene Consultant

Attachments:

- Appendix A: Summary of Sample Results with Recommendations
- Appendix B: Faucet Maps
- Appendix C: Laboratory Results for Lead in Drinking Water
- Appendix D: Missouri Revised Statutes – 160.077
- Appendix E: 3T's for Reducing Lead in Drinking Water in Schools and Child Care Facilities
- Appendix F: Highlights of the 3Ts for Reducing Lead in Drinking Water

APPENDIX A

Summary of Sample Results with Recommendations



District Name: Everton School District		Project Number: B5237060		State Action Level: 5 ppb		Notes		Recommendations					
Building Name	Floor/Room #/Name	Outlet Type	Outlet Name/Sink/Location	Aerator Screen (Y/N)	Sample #	Type (D/F)	Date	Time	Sampler Name	Results ppb	Notes	Recommendations	
Elementary Hallway	High School Hallway	WF	water fountain, gym hall entry	N	EES-H-WF-001	D	7/21/2023	9:23 AM	Mandy Carlson	<1.00		NA	
		WF	classroom water fountain	N	EES-IG-WF-002	D	7/21/2023	9:30 AM	Mandy Carlson	<1.00		NA	
		WF	classroom water fountain	N	EES-2G-WF-003	N		7/21/2023	9:32 AM	Mandy Carlson	<1.00		NA
		CF	classroom sink	Y	EES-1G-S-004	D		7/21/2023	9:38 AM	Mandy Carlson	<1.00	broken aerator	NA
		CF	classroom sink	Y	EES-2G-S-005	D		7/21/2023	9:40 AM	Mandy Carlson	<1.00		NA
		WF	classroom water fountain	N	EES-3G-WF-005	D		7/21/2023	9:45 AM	Mandy Carlson	<1.00		NA
		CF	classroom sink	Y	EES-3G-S-007	D		7/21/2023	9:46 AM	Mandy Carlson	<1.00		NA
		WF	classroom water fountain	Y	EES-K-WF-008	D		7/21/2023		Mandy Carlson	<1.00		NA
		CF	classroom sink	Y	EES-K-S-009	D		7/21/2023		Mandy Carlson	<1.00		NA
		CF	handwashing sink	Y	EES-K-HS-010	D		7/21/2023		Mandy Carlson	1.37		NA
Elementary Hallway	High School Hallway	WF	classroom water fountain	N	EES-4G-WF-011	D	7/21/2023		Mandy Carlson	<1.00		NA	
		CF	classroom sink	Y	EES-4G-S-012	D	7/21/2023		Mandy Carlson	<1.00		NA	
		BF	near 4th grade room, furthest from door faucet	Y	EES-GRR-S-013	D	7/21/2023		Mandy Carlson	1.59		NA	
		BF	middle faucet	Y	EES-GRR-S-014	D	7/21/2023		Mandy Carlson	2.49		NA	
		BF	closest to the door faucet	Y	EES-GRR-S-015	D	7/21/2023		Mandy Carlson	1.46		NA	
		WF	water fountain between restrooms	N	EES-H-WF-016	D	7/21/2023		Mandy Carlson	<1.00		NA	
		BF	near 4th grade room, furthest from door faucet	Y	EES-BRR-S-017	D	7/21/2023		Mandy Carlson	1.32		NA	
		BF	middle faucet	Y	EES-BRR-S-018	D	7/21/2023		Mandy Carlson	1.96		NA	
		BF	closest to the door faucet	Y	EES-BRR-S-019	D	7/21/2023		Mandy Carlson	1.38		NA	
		OF	office sink faucet	Y	EES-EO-S-020	D	7/21/2023		Mandy Carlson	4.83		NA	
Middle School Hallway	High School Hallway	WF	classroom water fountain	N	EES-SG-WF-021	D	7/21/2023		Mandy Carlson	<1.00		NA	
		CF	classroom sink	Y	EES-SG-S-022	D	7/21/2023		Mandy Carlson	<1.00		NA	
		WF	classroom water fountain	N	EES-TL-WF-023	D	7/21/2023		Mandy Carlson	<1.00		NA	
		CF	classroom sink	Y	EES-TL-S-024	D	7/21/2023		Mandy Carlson	<1.00		NA	
		CF	library sink faucet	N	EES-L-S-025	D	7/21/2023		Mandy Carlson	<1.00		NA	
		BF	near the library, faucet furthest from door	Y	EES-GRR-S-026	D	7/21/2023		Mandy Carlson	<1.00		NA	
		BF	near the library, faucet closest to door	Y	EES-GRR-S-027	D	7/21/2023		Mandy Carlson	<1.00		NA	
		BF	near the library, faucet furthest from door	Y	EES-BRR-S-028	D	7/21/2023		Mandy Carlson	<1.00		NA	
		BF	near the library, faucet closest to door	Y	EES-BRR-S-029	D	7/21/2023		Mandy Carlson	<1.00		NA	
		LF	sink in locker room	Y	EHS-BUR-S-030	D	7/21/2023		Mandy Carlson	1.81		NA	
Middle School Hallway	High School Hallway	LF	sink in locker room	Y	EHS-GUR-S-031	D	7/21/2023		Mandy Carlson	9.42		Post a "Not for Drinking" Sign or Flush each morning as temporary measure. Take out of service and/or replace. Perform flush (2nd draw) sampling.	
		KF	sink faucet	Y	EHS-CS-S-032	D	7/21/2023		Mandy Carlson	1.13		NA	
		KF	dish sink	Y	EHS-C-S-033	D	7/21/2023		Mandy Carlson	3.25		NA	
		KF	handwashing sink	Y	EHS-C-HS-034	D	7/21/2023		Mandy Carlson	5		Post a "Not for Drinking" Sign or Flush each morning as temporary measure. Take out of service and/or replace. Perform flush (2nd draw) sampling.	
		CF	sink faucet furthest from door	Y	EHS-AB-S-035	D	7/21/2023		Mandy Carlson	NA		NA	
		CF	sink faucet closest to door	Y	EHS-AB-S-036	D	8/4/2023		Mandy Carlson	3.4		NA	
		CF	sink faucet	Y	EHS-MR-S-037	D	7/21/2023		Mandy Carlson	2		sample lost during transit	
		BF	faucet furthest from door	Y	EHS-GRR-S-038	D	7/21/2023		Mandy Carlson	6.57		Post a "Not for Drinking" Sign or Flush each morning as temporary measure. Take out of service and/or replace. Perform flush (2nd draw) sampling.	
		BF	faucet closest to door	Y	EHS-GRR-S-039	D	7/21/2023		Mandy Carlson	3.95		NA	

Notes - Notes are about anything out of the ordinary found during sampling. Examples of Notes: automatic hand sensor, water odor, change in water color, low water flow, irregular water spray, does water become warm/flat, water filter attached to faucet, leaky faucet.
 Recommendations - All samples with a value above 5 ppb should be re-sampled with a flush sample.
 *Flushing and "Do not drink from faucet" signs are only temporary solutions.
 *Any faucet with a value above 15 ppb should be removed from service and/or replaced immediately.
 *All values above 5.0 ppb must be remediated as soon as possible.
 *Elementary schools, Kindergarten, Pre-K and day care are highest priorities.



Location	BF	CF	WF	Room	Y	EHS-8RR-S-040	D	7/21/2023	Inspector	Result	Notes
Boy's restroom	BF				Y		D	7/21/2023	Mindy Carlson	12.1	Post a "Not for Drinking" sign or flush each morning as temporary measure. Take out of service and/or replace. Perform flush (end draw) sampling.
Science Room	CF				Y	EHS-SRS-041	D	7/21/2023	Mindy Carlson	2.95	NA
Science Room	CF			furthest from door middle faucet	Y	EHS-SRS-042	D	7/21/2023	Mindy Carlson	4.16	NA
Science Room	CF			closest to the door	Y	EHS-SRS-043	D	7/21/2023	Mindy Carlson	8.53	Post a "Not for Drinking" sign or flush each morning as temporary measure. Take out of service and/or replace. Perform flush (end draw) sampling.
Hallway	WF			near science room, water fountain	N	EHS-H-WF-044	D	7/21/2023	Mindy Carlson	<1.00	NA

Res B-314 = at or above state action level
 ppb = parts per billion
 < = below laboratory reporting limit



District Name: Everton School District Campus Name: AG Building		Project Number: 85237060				State Action Level: 5 ppb						
<p>Notes: - Notes are about anything out of the ordinary found during sampling. Examples of Notes: automatic hand sensor, water odor, change in water color, low water flow, irregular water spray, does water become warm/hot, water filter attached to faucet, leaky faucet.</p> <p>Recommendations: - All samples with a value above 5 ppb should be re-sampled with a Flush sample. *Flushing and "Do not drink from faucet" signs are only temporary solutions. *Taking a faucet out of service, fillers and/or replacement of lead components are permanent solutions. *Any faucet with a value above 15 ppb should be removed from service and/or replaced immediately. *All values above 5.0 ppb must be remediated as soon as possible. *Elementary schools, Kindergarten, Pre-K and day care are highest priorities.</p>												
Faucet Testing												
<p>Faucet Inventory (outlet types: Classroom Faucet-CF, Hall Fountain-HF, Kitchen Faucet-KF, Bath Faucet-BF, Ice Maker-IM, Locker Room Faucet-LF, Water Fountain Chilled-WF, Nurse Room Faucet-NF, Teacher Room Faucet-TF, Shop Faucet-SF, Coffee Maker (Java)-JF, Other Faucet-OF (describe)), Bottle Refill Faucet-BF</p>												
Building Name	Floor/Room #/Name	Outlet Type	Outlet Name/Sink/Location	Aerator Screen (Y/N)	Sample #	Type (D,F)	Date	Time	Sampler Name	Results ppb	Notes	Recommendations
Agriculture Building/Shop	AG Building	BF	shop sink	N	AgS-045	D	7/21/2023		Mandy Carlson	12.3		Post a "Not for Drinking" Sign or Flush each morning as temporary measure. Take out of service and/or replace. Perform flush (and draw) sampling.

Red Bold = at or above state action level
 ppb = parts per billion
 < = below laboratory reporting limit



District Name: Everton School District		Project Number: 85237060		State Action Level: 5 ppb		Notes - Notes are about anything out of the ordinary found during sampling. Examples of Notes: automatic hand sensor, water odor, change in water color, low water flow, irregular water spray, does water become warm/hot, water filter attached to faucet, leaky faucet						
Campus Name: Pre-School Building		Faucet Testing		Results ppb		Recommendations						
Building Name	Floor/Room #/Name	Outlet Type	Outlet Name/Sink/Location	Aerator Screen (Y/N)	Sample #	Type (D/F)	Date	Time	Sampler Name	Results ppb	Notes	Recommendations
Pre-School Building	preschool kitchen	KF	kitchen faucet	Y	EPS-KS-046	D	8/4/2023		Mandy Carlson	3.6		NA
	restroom	BF	restroom faucet on right side	Y	EPS-RIS-047	D	7/31/2023		Mandy Carlson	3.8		NA
	restroom	BF	restroom faucet on left side	Y	EPS-RIS-048	D	7/31/2023		Mandy Carlson	1.18		NA

Red field = at or above state action level
 ppb = parts per billion
 < = below laboratory reporting limit

APPENDIX B

Faucet Maps

NTURN SINKS

Everton R-III Schools Emergency Map

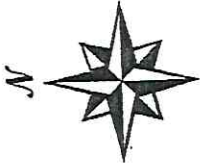

LEGEND

- S = sink faucet
- WF = water faucet
- RR = restroom
- Red indicates lead greater than 5 parts per billion

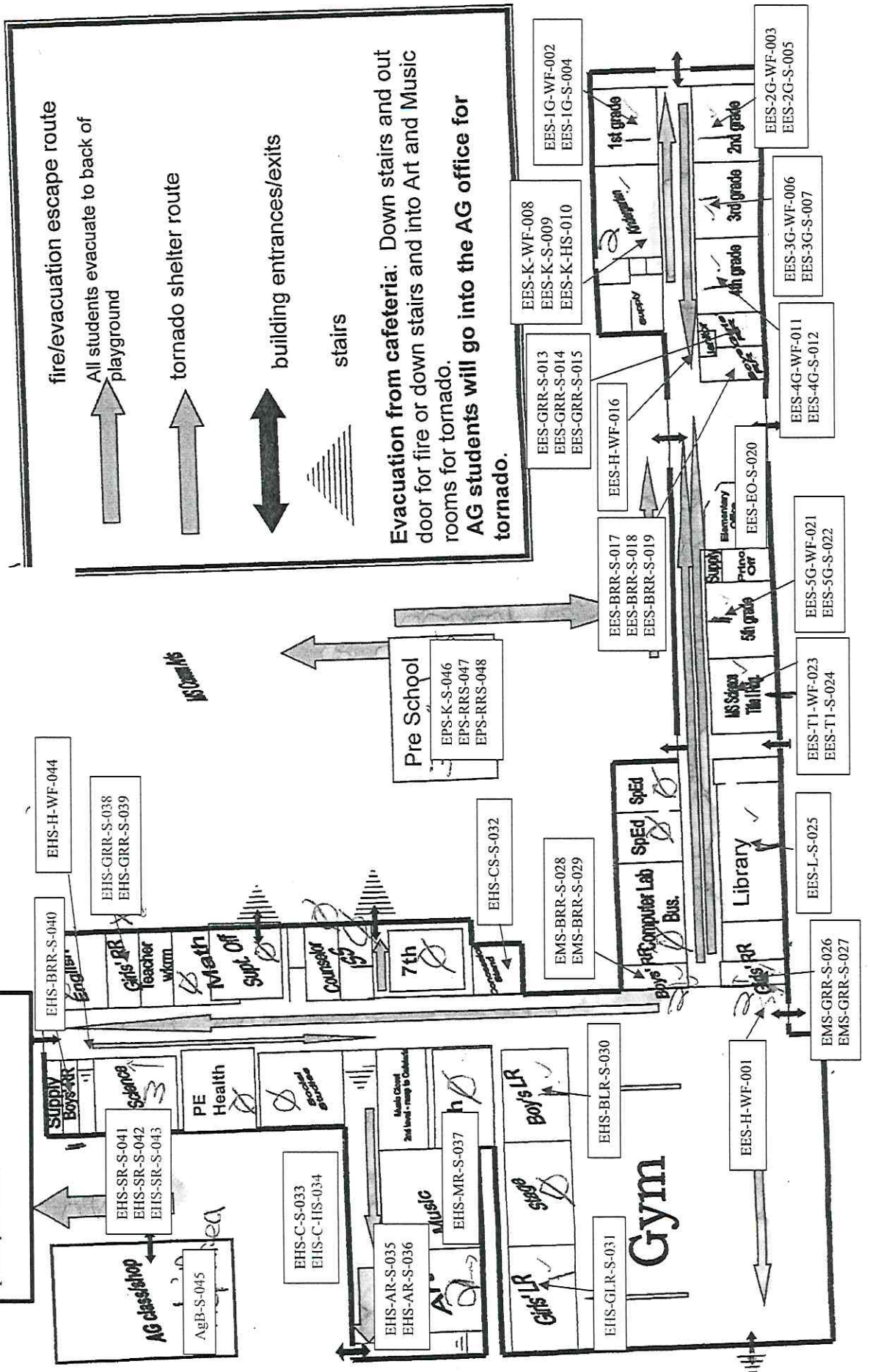

APPENDIX C

Laboratory Results for Lead in Drinking Water



Pace Analytical Services, LLC
2231 W. Altorfer Drive
Peoria, IL 61615
(800)752-6651

September 08, 2023

Mandy Carlson
Terracon - Springfield MO
4765 Junction Street
Springfield, MO 65802

RE: Drinking Water Lead

Dear Mandy Carlson:

Please find enclosed the analytical results for the **48** sample(s) the laboratory received on **7/26/23 12:00 pm** and logged in under work order **GG04963**. All testing is performed according to our current TNI accreditations unless otherwise noted. This report cannot be reproduced, except in full, without the written permission of Pace Analytical Services, LLC.

If you have any questions regarding your report, please contact your project manager. Quality and timely data is of the utmost importance to us.

Pace Analytical Services appreciates the opportunity to provide you with analytical expertise. We are always trying to improve our customer service and we welcome you to contact the General Manager, Lisa Grant, with any feedback you have about your experience with our laboratory at 309-683-1764 or lisa.grant@pacelabs.com.

A handwritten signature in black ink, appearing to read "Chenise Lambert-Sykes".

Chenise Lambert-Sykes
Project Manager
(314)432-0550
Chenise.Lambert-Sykes@pacelabs.com



SAMPLE RECEIPT CHECK LIST

Items not applicable will be marked as in compliance

Work Order GG04963

YES	Samples received within temperature compliance when applicable
YES	COC present upon sample receipt
YES	COC completed & legible
YES	Sampler name & signature present
YES	Unique sample IDs assigned
YES	Sample collection location recorded
YES	Date & time collected recorded on COC
YES	Relinquished by client signature on COC
YES	COC & labels match
YES	Sample labels are legible
YES	Appropriate bottle(s) received
YES	Sufficient sample volume received
YES	Sample containers received undamaged
NO	Zero headspace, <6 mm present in VOA vials
NO	Trip blank(s) received
YES	All non-field analyses received within holding times
NO	Short hold time analysis
YES	Current PDC COC submitted
NO	Case narrative provided



Pace Analytical Services, LLC
2231 W. Altorfer Drive
Peoria, IL 61615
(800)752-6651

Case Narrative

Sample EHS-AR-S-035 (GG04963-35) is missing and therefore cannot be reported.

The following samples were compromised and cannot be reported:

EHS-AR-S-036 (GG04963-36)

EHS-MR-S-037 (GG04963-37)

EPS-K-S-046 (GG04963-48)



ANALYTICAL RESULTS

Sample: GG04963-01
 Name: EES-4G-S-012
 Matrix: Drinking Water - Grab

Sampled: 07/21/23 00:00
 Received: 07/26/23 12:00

Parameter	Result	Unit	Qualifier	Prepared	Dilution	MRL	Analyzed	Analyst	Method
Total Metals - PIA									
Lead	< 1.00	ug/L		08/24/23 13:21	1	1.00	08/26/23 14:20	TJJ	EPA 200.8 REV 5.4

Sample: GG04963-02
 Name: EES-GRR-S-013
 Matrix: Drinking Water - Grab

Sampled: 07/21/23 00:00
 Received: 07/26/23 12:00

Parameter	Result	Unit	Qualifier	Prepared	Dilution	MRL	Analyzed	Analyst	Method
Total Metals - PIA									
Lead	1.59	ug/L		08/24/23 13:21	1	1.00	08/30/23 10:51	KMC	EPA 200.8 REV 5.4

Sample: GG04963-03
 Name: EES-GRR-S-014
 Matrix: Drinking Water - Grab

Sampled: 07/21/23 00:00
 Received: 07/26/23 12:00

Parameter	Result	Unit	Qualifier	Prepared	Dilution	MRL	Analyzed	Analyst	Method
Total Metals - PIA									
Lead	2.49	ug/L		08/24/23 13:21	1	1.00	08/26/23 14:23	TJJ	EPA 200.8 REV 5.4

Sample: GG04963-04
 Name: EES-GRR-S-015
 Matrix: Drinking Water - Grab

Sampled: 07/21/23 00:00
 Received: 07/26/23 12:00

Parameter	Result	Unit	Qualifier	Prepared	Dilution	MRL	Analyzed	Analyst	Method
Total Metals - PIA									
Lead	1.46	ug/L		08/24/23 13:21	1	1.00	08/26/23 14:25	TJJ	EPA 200.8 REV 5.4



ANALYTICAL RESULTS

Sample: GG04963-05
 Name: EES-H-WF-016
 Matrix: Drinking Water - Grab

Sampled: 07/21/23 00:00
 Received: 07/26/23 12:00

Parameter	Result	Unit	Qualifier	Prepared	Dilution	MRL	Analyzed	Analyst	Method
Total Metals - PIA									
Lead	< 1.00	ug/L		08/24/23 13:21	1	1.00	08/26/23 14:26	TJJ	EPA 200.8 REV 5.4

Sample: GG04963-06
 Name: EES-BRR-S-017
 Matrix: Drinking Water - Grab

Sampled: 07/21/23 00:00
 Received: 07/26/23 12:00

Parameter	Result	Unit	Qualifier	Prepared	Dilution	MRL	Analyzed	Analyst	Method
Total Metals - PIA									
Lead	1.32	ug/L		08/24/23 13:21	1	1.00	08/26/23 14:28	TJJ	EPA 200.8 REV 5.4

Sample: GG04963-07
 Name: EES-BRR-S-018
 Matrix: Drinking Water - Grab

Sampled: 07/21/23 00:00
 Received: 07/26/23 12:00

Parameter	Result	Unit	Qualifier	Prepared	Dilution	MRL	Analyzed	Analyst	Method
Total Metals - PIA									
Lead	1.96	ug/L		08/24/23 13:21	1	1.00	08/26/23 14:30	TJJ	EPA 200.8 REV 5.4

Sample: GG04963-08
 Name: EES-BRR-S-019
 Matrix: Drinking Water - Grab

Sampled: 07/21/23 00:00
 Received: 07/26/23 12:00

Parameter	Result	Unit	Qualifier	Prepared	Dilution	MRL	Analyzed	Analyst	Method
Total Metals - PIA									
Lead	1.38	ug/L		08/24/23 13:21	1	1.00	08/30/23 10:56	KMC	EPA 200.8 REV 5.4



ANALYTICAL RESULTS

Sample: GG04963-09
 Name: EES-EO-S-020
 Matrix: Drinking Water - Grab

Sampled: 07/21/23 00:00
 Received: 07/26/23 12:00

Parameter	Result	Unit	Qualifier	Prepared	Dilution	MRL	Analyzed	Analyst	Method
Total Metals - PIA									
Lead	4.83	ug/L		08/24/23 13:21	1	1.00	08/30/23 10:59	KMC	EPA 200.8 REV 5.4

Sample: GG04963-10
 Name: EES-5G-WF-021
 Matrix: Drinking Water - Grab

Sampled: 07/21/23 00:00
 Received: 07/26/23 12:00

Parameter	Result	Unit	Qualifier	Prepared	Dilution	MRL	Analyzed	Analyst	Method
Total Metals - PIA									
Lead	< 1.00	ug/L		08/24/23 13:21	1	1.00	08/30/23 11:01	KMC	EPA 200.8 REV 5.4

Sample: GG04963-11
 Name: EES-5G-WF-022
 Matrix: Drinking Water - Grab

Sampled: 07/21/23 00:00
 Received: 07/26/23 12:00

Parameter	Result	Unit	Qualifier	Prepared	Dilution	MRL	Analyzed	Analyst	Method
Total Metals - PIA									
Lead	< 1.00	ug/L		08/24/23 13:21	1	1.00	08/30/23 11:02	KMC	EPA 200.8 REV 5.4

Sample: GG04963-12
 Name: EES-H-WF-001
 Matrix: Drinking Water - Grab

Sampled: 07/21/23 00:00
 Received: 07/26/23 12:00

Parameter	Result	Unit	Qualifier	Prepared	Dilution	MRL	Analyzed	Analyst	Method
Total Metals - PIA									
Lead	< 1.00	ug/L		08/24/23 13:21	1	1.00	08/26/23 14:45	TJJ	EPA 200.8 REV 5.4



ANALYTICAL RESULTS

Sample: GG04963-13
 Name: EES-1G-WF-002
 Matrix: Drinking Water - Grab

Sampled: 07/21/23 00:00
 Received: 07/26/23 12:00

Parameter	Result	Unit	Qualifier	Prepared	Dilution	MRL	Analyzed	Analyst	Method
Total Metals - PIA									
Lead	< 1.00	ug/L		08/24/23 13:21	1	1.00	08/26/23 14:46	TJJ	EPA 200.8 REV 5.4

Sample: GG04963-14
 Name: EES-2G-WF-003
 Matrix: Drinking Water - Grab

Sampled: 07/21/23 00:00
 Received: 07/26/23 12:00

Parameter	Result	Unit	Qualifier	Prepared	Dilution	MRL	Analyzed	Analyst	Method
Total Metals - PIA									
Lead	< 1.00	ug/L		08/24/23 13:21	1	1.00	08/26/23 14:48	TJJ	EPA 200.8 REV 5.4

Sample: GG04963-15
 Name: EES-1G-S-004
 Matrix: Drinking Water - Grab

Sampled: 07/21/23 00:00
 Received: 07/26/23 12:00

Parameter	Result	Unit	Qualifier	Prepared	Dilution	MRL	Analyzed	Analyst	Method
Total Metals - PIA									
Lead	< 1.00	ug/L		08/24/23 13:21	1	1.00	08/26/23 14:50	TJJ	EPA 200.8 REV 5.4

Sample: GG04963-16
 Name: EES-2G-S-005
 Matrix: Drinking Water - Grab

Sampled: 07/21/23 00:00
 Received: 07/26/23 12:00

Parameter	Result	Unit	Qualifier	Prepared	Dilution	MRL	Analyzed	Analyst	Method
Total Metals - PIA									
Lead	< 1.00	ug/L		08/24/23 13:21	1	1.00	08/26/23 14:52	TJJ	EPA 200.8 REV 5.4



ANALYTICAL RESULTS

Sample: GG04963-17
 Name: EES-3G-WF-006
 Matrix: Drinking Water - Grab

Sampled: 07/21/23 00:00
 Received: 07/26/23 12:00

Parameter	Result	Unit	Qualifier	Prepared	Dilution	MRL	Analyzed	Analyst	Method
Total Metals - PIA									
Lead	< 1.00	ug/L		08/24/23 13:21	1	1.00	08/26/23 14:53	TJJ	EPA 200.8 REV 5.4

Sample: GG04963-18
 Name: EES-3G-S-007
 Matrix: Drinking Water - Grab

Sampled: 07/21/23 00:00
 Received: 07/26/23 12:00

Parameter	Result	Unit	Qualifier	Prepared	Dilution	MRL	Analyzed	Analyst	Method
Total Metals - PIA									
Lead	< 1.00	ug/L		08/24/23 13:21	1	1.00	08/26/23 14:58	TJJ	EPA 200.8 REV 5.4

Sample: GG04963-19
 Name: EES-K-WF-008
 Matrix: Drinking Water - Grab

Sampled: 07/21/23 00:00
 Received: 07/26/23 12:00

Parameter	Result	Unit	Qualifier	Prepared	Dilution	MRL	Analyzed	Analyst	Method
Total Metals - PIA									
Lead	< 1.00	ug/L		08/24/23 13:21	1	1.00	08/26/23 15:03	TJJ	EPA 200.8 REV 5.4

Sample: GG04963-20
 Name: EES-K-S-009
 Matrix: Drinking Water - Grab

Sampled: 07/21/23 00:00
 Received: 07/26/23 12:00

Parameter	Result	Unit	Qualifier	Prepared	Dilution	MRL	Analyzed	Analyst	Method
Total Metals - PIA									
Lead	< 1.00	ug/L		08/24/23 13:21	1	1.00	08/26/23 15:05	TJJ	EPA 200.8 REV 5.4



ANALYTICAL RESULTS

Sample: GG04963-21
 Name: EES-K-HS-010
 Matrix: Drinking Water - Grab

Sampled: 07/21/23 00:00
 Received: 07/26/23 12:00

Parameter	Result	Unit	Qualifier	Prepared	Dilution	MRL	Analyzed	Analyst	Method
Total Metals - PIA									
Lead	1.37	ug/L		08/24/23 13:21	1	1.00	08/26/23 15:07	TJJ	EPA 200.8 REV 5.4

Sample: GG04963-22
 Name: EES-4G-WF-011
 Matrix: Drinking Water - Grab

Sampled: 07/21/23 00:00
 Received: 07/26/23 12:00

Parameter	Result	Unit	Qualifier	Prepared	Dilution	MRL	Analyzed	Analyst	Method
Total Metals - PIA									
Lead	< 1.00	ug/L		08/24/23 13:21	1	1.00	08/26/23 15:08	TJJ	EPA 200.8 REV 5.4

Sample: GG04963-23
 Name: EES-TI-WF-023
 Matrix: Drinking Water - Grab

Sampled: 07/21/23 00:00
 Received: 07/26/23 12:00

Parameter	Result	Unit	Qualifier	Prepared	Dilution	MRL	Analyzed	Analyst	Method
Total Metals - PIA									
Lead	< 1.00	ug/L		08/24/23 13:21	1	1.00	08/26/23 15:10	TJJ	EPA 200.8 REV 5.4

Sample: GG04963-24
 Name: EES-TI-S-024
 Matrix: Drinking Water - Grab

Sampled: 07/21/23 00:00
 Received: 07/26/23 12:00

Parameter	Result	Unit	Qualifier	Prepared	Dilution	MRL	Analyzed	Analyst	Method
Total Metals - PIA									
Lead	< 1.00	ug/L		08/24/23 13:21	1	1.00	08/26/23 15:12	TJJ	EPA 200.8 REV 5.4



ANALYTICAL RESULTS

Sample: GG04963-25
 Name: EES-L-S-025
 Matrix: Drinking Water - Grab

Sampled: 07/21/23 00:00
 Received: 07/26/23 12:00

Parameter	Result	Unit	Qualifier	Prepared	Dilution	MRL	Analyzed	Analyst	Method
Total Metals - PIA									
Lead	< 1.00	ug/L		08/24/23 13:21	1	1.00	08/26/23 15:13	TJJ	EPA 200.8 REV 5.4

Sample: GG04963-26
 Name: EMS-GRR-S-026
 Matrix: Drinking Water - Grab

Sampled: 07/21/23 00:00
 Received: 07/26/23 12:00

Parameter	Result	Unit	Qualifier	Prepared	Dilution	MRL	Analyzed	Analyst	Method
Total Metals - PIA									
Lead	< 1.00	ug/L		08/24/23 13:21	1	1.00	08/26/23 15:18	TJJ	EPA 200.8 REV 5.4

Sample: GG04963-27
 Name: EMS-GRR-S-027
 Matrix: Drinking Water - Grab

Sampled: 07/21/23 00:00
 Received: 07/26/23 12:00

Parameter	Result	Unit	Qualifier	Prepared	Dilution	MRL	Analyzed	Analyst	Method
Total Metals - PIA									
Lead	< 1.00	ug/L		08/24/23 13:21	1	1.00	08/26/23 15:20	TJJ	EPA 200.8 REV 5.4

Sample: GG04963-28
 Name: EMS-BRR-S-028
 Matrix: Drinking Water - Grab

Sampled: 07/21/23 00:00
 Received: 07/26/23 12:00

Parameter	Result	Unit	Qualifier	Prepared	Dilution	MRL	Analyzed	Analyst	Method
Total Metals - PIA									
Lead	< 1.00	ug/L		08/24/23 13:21	1	1.00	08/26/23 15:22	TJJ	EPA 200.8 REV 5.4



ANALYTICAL RESULTS

Sample: GG04963-29
 Name: EMS-BRR-S-029
 Matrix: Drinking Water - Grab

Sampled: 07/21/23 00:00
 Received: 07/26/23 12:00

Parameter	Result	Unit	Qualifier	Prepared	Dilution	MRL	Analyzed	Analyst	Method
Total Metals - PIA									
Lead	< 1.00	ug/L		08/24/23 13:21	1	1.00	08/26/23 15:27	TJJ	EPA 200.8 REV 5.4

Sample: GG04963-30
 Name: EHS-BLR-S-030
 Matrix: Drinking Water - Grab

Sampled: 07/21/23 00:00
 Received: 07/26/23 12:00

Parameter	Result	Unit	Qualifier	Prepared	Dilution	MRL	Analyzed	Analyst	Method
Total Metals - PIA									
Lead	1.81	ug/L		08/24/23 13:21	1	1.00	08/26/23 15:28	TJJ	EPA 200.8 REV 5.4

Sample: GG04963-31
 Name: EHS-GLR-S-031
 Matrix: Drinking Water - Grab

Sampled: 07/21/23 00:00
 Received: 07/26/23 12:00

Parameter	Result	Unit	Qualifier	Prepared	Dilution	MRL	Analyzed	Analyst	Method
Total Metals - PIA									
Lead	9.42	ug/L		08/23/23 12:12	1	1.00	08/25/23 10:22	KMC	EPA 200.8 REV 5.4

Sample: GG04963-32
 Name: EHS-CS-S-032
 Matrix: Drinking Water - Grab

Sampled: 07/21/23 00:00
 Received: 07/26/23 12:00

Parameter	Result	Unit	Qualifier	Prepared	Dilution	MRL	Analyzed	Analyst	Method
Total Metals - PIA									
Lead	1.13	ug/L		08/23/23 12:12	1	1.00	08/25/23 10:24	KMC	EPA 200.8 REV 5.4



ANALYTICAL RESULTS

Sample: GG04963-33
 Name: EHS-C-S-033
 Matrix: Drinking Water - Grab

Sampled: 07/21/23 00:00
 Received: 07/26/23 12:00

Parameter	Result	Unit	Qualifier	Prepared	Dilution	MRL	Analyzed	Analyst	Method
Total Metals - PIA									
Lead	3.25	ug/L		08/23/23 12:12	1	1.00	08/25/23 10:26	KMC	EPA 200.8 REV 5.4

Sample: GG04963-34
 Name: EHS-C-HS-034
 Matrix: Drinking Water - Grab

Sampled: 07/21/23 00:00
 Received: 07/26/23 12:00

Parameter	Result	Unit	Qualifier	Prepared	Dilution	MRL	Analyzed	Analyst	Method
Total Metals - PIA									
Lead	5.00	ug/L		08/23/23 12:12	1	1.00	08/25/23 10:27	KMC	EPA 200.8 REV 5.4

Sample: GG04963-38
 Name: EHS-GRR-S-038
 Matrix: Drinking Water - Grab

Sampled: 07/21/23 00:00
 Received: 07/26/23 12:00

Parameter	Result	Unit	Qualifier	Prepared	Dilution	MRL	Analyzed	Analyst	Method
Total Metals - PIA									
Lead	6.97	ug/L		08/23/23 12:12	1	1.00	08/25/23 10:33	KMC	EPA 200.8 REV 5.4

Sample: GG04963-39
 Name: EHS-GRR-S-039
 Matrix: Drinking Water - Grab

Sampled: 07/21/23 00:00
 Received: 07/26/23 12:00

Parameter	Result	Unit	Qualifier	Prepared	Dilution	MRL	Analyzed	Analyst	Method
Total Metals - PIA									
Lead	3.95	ug/L		08/23/23 12:12	1	1.00	08/25/23 10:35	KMC	EPA 200.8 REV 5.4



ANALYTICAL RESULTS

Sample: GG04963-40
 Name: EHS-BRR-S-040
 Matrix: Drinking Water - Grab

Sampled: 07/21/23 00:00
 Received: 07/26/23 12:00

Parameter	Result	Unit	Qualifier	Prepared	Dilution	MRL	Analyzed	Analyst	Method
Total Metals - PIA									
Lead	12.1	ug/L		08/23/23 12:12	1	1.00	08/25/23 10:36	KMC	EPA 200.8 REV 5.4

Sample: GG04963-41
 Name: EHS-SR-S-041
 Matrix: Drinking Water - Grab

Sampled: 07/21/23 00:00
 Received: 07/26/23 12:00

Parameter	Result	Unit	Qualifier	Prepared	Dilution	MRL	Analyzed	Analyst	Method
Total Metals - PIA									
Lead	2.95	ug/L		08/23/23 12:12	1	1.00	08/25/23 10:41	KMC	EPA 200.8 REV 5.4

Sample: GG04963-42
 Name: EHS-SR-S-042
 Matrix: Drinking Water - Grab

Sampled: 07/21/23 00:00
 Received: 07/26/23 12:00

Parameter	Result	Unit	Qualifier	Prepared	Dilution	MRL	Analyzed	Analyst	Method
Total Metals - PIA									
Lead	4.14	ug/L		08/23/23 12:12	1	1.00	08/25/23 10:43	KMC	EPA 200.8 REV 5.4

Sample: GG04963-43
 Name: EHS-SR-S-043
 Matrix: Drinking Water - Grab

Sampled: 07/21/23 00:00
 Received: 07/26/23 12:00

Parameter	Result	Unit	Qualifier	Prepared	Dilution	MRL	Analyzed	Analyst	Method
Total Metals - PIA									
Lead	8.53	ug/L		08/23/23 12:12	1	1.00	08/25/23 10:44	KMC	EPA 200.8 REV 5.4



ANALYTICAL RESULTS

Sample: GG04963-44
 Name: EHS-H-WF-044
 Matrix: Drinking Water - Grab

Sampled: 07/21/23 00:00
 Received: 07/26/23 12:00

Parameter	Result	Unit	Qualifier	Prepared	Dilution	MRL	Analyzed	Analyst	Method
Total Metals - PIA									
Lead	< 1.00	ug/L		08/23/23 12:12	1	1.00	08/25/23 10:46	KMC	EPA 200.8 REV 5.4

Sample: GG04963-45
 Name: AgB-S-045
 Matrix: Drinking Water - Grab

Sampled: 07/21/23 00:00
 Received: 07/26/23 12:00

Parameter	Result	Unit	Qualifier	Prepared	Dilution	MRL	Analyzed	Analyst	Method
Total Metals - PIA									
Lead	12.3	ug/L		08/23/23 12:12	1	1.00	08/25/23 10:50	KMC	EPA 200.8 REV 5.4

Sample: GG04963-46
 Name: EPS-RRS-047
 Matrix: Drinking Water - Grab

Sampled: 07/21/23 00:00
 Received: 07/26/23 12:00

Parameter	Result	Unit	Qualifier	Prepared	Dilution	MRL	Analyzed	Analyst	Method
Total Metals - PIA									
Lead	3.80	ug/L		08/23/23 12:41	1	1.00	08/26/23 15:39	KMC	EPA 200.8 REV 5.4

Sample: GG04963-47
 Name: EPS-RRS-048
 Matrix: Drinking Water - Grab

Sampled: 07/21/23 00:00
 Received: 07/26/23 12:00

Parameter	Result	Unit	Qualifier	Prepared	Dilution	MRL	Analyzed	Analyst	Method
Total Metals - PIA									
Lead	1.18	ug/L		08/23/23 12:41	1	1.00	08/26/23 15:40	KMC	EPA 200.8 REV 5.4



NOTES

Specifications regarding method revisions, method modifications, and calculations used for analysis are available upon request. Please contact your project manager.

* Not a TNI accredited analyte

Certifications

CHI - McHenry, IL - 4314-A W. Crystal Lake Road, McHenry, IL 60050
TNI Accreditation for Drinking Water and Wastewater Fields of Testing through IL EPA Accreditation No. 100279
Illinois Department of Public Health Bacterial Analysis in Drinking Water Approved Laboratory Registry No. 17556

PIA - Peoria, IL - 2231 W. Altorfer Drive, Peoria, IL 61615
TNI Accreditation for Drinking Water, Wastewater, Solid and Hazardous Material Fields of Testing through IL EPA Accreditation No. 100230
Illinois Department of Public Health Bacterial Analysis in Drinking Water Approved Laboratory Registry No. 17553
Drinking Water Certifications/Accreditations: Iowa (240); Kansas (E-10338); Missouri (870)
Wastewater Certifications/Accreditations: Arkansas (88-0677); Iowa (240); Kansas (E-10338)
Solid and Hazardous Material Certifications/Accreditations: Arkansas (88-0677); Iowa (240); Kansas (E-10338)

SPMO - Springfield, MO - 1805 W Sunset Street, Springfield, MO 65807
USEPA DMR-QA Program

STL - Hazelwood, MO - 944 Anglum Rd, Hazelwood, MO 63042
TNI Accreditation for Wastewater, Solid and Hazardous Material Fields of Testing through KS KDHE Certification No. E-10389
TNI Accreditation for Wastewater, Solid and Hazardous Material Fields of Testing through IL EPA Accreditation No. - 200080
Illinois Department of Public Health Bacterial Analysis in Drinking Water Approved Laboratory, Registry No. 171050
Missouri Department of Natural Resources - Certificate of Approval for Microbiological Laboratory Service - No. 1050



Certified by: Chenise Lambert-Sykes, Project Manager

REGULATORY PROGRAM (CIRCLE): NPDES MORBCA CCDD
 MORBCA
 TACO: RES OR IND/COMM

ALL HIGHLIGHTED AREAS MUST BE COMPLETED BY CLIENT (PLEASE PRINT)

1 CLIENT Terrace Consultants 4705 W Junctions Springfield, MD 20802 CONTACT PERSON Mandy Carlsson		PROJECT LOCATION Everton E-MAIL Mandy.Carlsson@terracecon.com		PURCHASE ORDER # 135337060 PHONE NUMBER 417-264-5100		DATE SHIPPED _____		ANALYSIS REQUESTED 3 Method 800.		(FOR LAB USE ONLY) 4 LOGIN # 6604963 LOGGED BY: SB CLIENT: PROJECT: PROJ. MGR: CUSTODY SEAL #:	
2 SAMPLE DESCRIPTION (UNIQUE DESCRIPTION AS IT WILL APPEAR ON THE ANALYTICAL REPORT) EES-46-S-012 EES-GRR-S-013 EES-GRR-S-014 EES-H-WF-016 EES-BRR-S-017 EES-BRR-S-018 EES-BRR-S-019 EES-EO-S-020 EES-54-WF-021 EES-54-S-022		DATE COLLECTED 7/21/23		TIME COLLECTED _____		SAMPLE TYPE COMP _____		MATRIX TYPE DW		BOTTLE COUNT 1	
MATRIX TYPES: HW-WASTEWATER HW-DRAINAGE WATER GW-GROUND WATER WW-SLUDGE LW-LEACHATE LW-LEACHATE OIL-OIL SOL-SOLID		PRES CODE CLIENT PROVIDED 6		DATE COLLECTED _____		TIME COLLECTED _____		SAMPLE TYPE COMP _____		MATRIX TYPE _____	
CHEMICAL PRESERVATION CODES: 1-HCL 2-H2SO4 3-HNO3 4-NAOH 5-NA2S2O3 6-UNPRESERVED 7-OTHER		DATE RESULTS NEEDED 10-Days		RECEIVED BY: (SIGNATURE) _____		RECEIVED BY: (SIGNATURE) _____		RECEIVED BY: (SIGNATURE) _____		COMMENTS: (FOR LAB USE ONLY) 6 _____	
5 TURNAROUND TIME REQUESTED (PLEASE CIRCLE) (RUSH TAT IS SUBJECT TO PACE LABS APPROVAL AND SURCHARGE) NORMAL RUSH RUSH RESULTS VIA (PLEASE CIRCLE) EMAIL PHONE 10-Days		DATE 7/24/23 TIME 16:00		DATE _____ TIME _____		DATE 7/26/23 TIME 1200		DATE _____ TIME _____		SAMPLE TEMPERATURE UPON RECEIPT _____ °C CHILL PROCESS STARTED PRIOR TO RECEIPT SAMPLE(S) RECEIVED ON ICE SAMPLE ACCEPTANCE NONCONFORMANT REPORT IS NEEDED DATE AND TIME TAKEN FROM SAMPLE BOTTLE	
7 RELINQUISHED BY: (SIGNATURE) _____		RELINQUISHED BY: (SIGNATURE) _____		RELINQUISHED BY: (SIGNATURE) _____		RECEIVED BY: (SIGNATURE) _____		RECEIVED BY: (SIGNATURE) _____		RECEIVED BY: (SIGNATURE) _____	

CHAIN OF CUSTODY RECORD
SAMPLE COLLECTED IN THE STATE OF MO

REGULATORY PROGRAM (CIRCLE):	NPDES
MORBCA	RCRA
CCDD	TACO: RES OR IND/COMM

PACE ANALYTICAL SERVICES
WWW.PACELABS.COM

ALL HIGHLIGHTED AREAS MUST BE COMPLETED BY CLIENT (PLEASE PRINT)

1 CLIENT Terracon Consultants ADDRESS 4765 W. Junction CITY Springfield, Mo 65802 STATE CONTACT PERSON Mandy Carlson		PROJECT LOCATION Everton E-MAIL Mandy.Carlson@terracon.com		PURCHASE ORDER # 05307060 PHONE NUMBER 417-264-5100 DATE SHIPPED		ANALYSIS REQUESTED Method 800.0		(FOR LAB USE ONLY) LOGIN # LOGGED BY: CLIENT: PROJECT: PROJ. MGR.: CUSTODY SEAL #: REMARKS	
2 SAMPLE DESCRIPTION (UNIQUE DESCRIPTION AS IT WILL APPEAR ON THE ANALYTICAL REPORT) EES-H-WF-001 EES-1G-WF-003 EES-3G-WF-003 EES-1G-S-004 EES-3G-S-005 EES-3G-WF-006 EES-3G-S-007 EES-K-WF-008 EES-K-S-004 EES-K-HS-010 EES-4G-WF-011		DATE COLLECTED 7/24/23	TIME COLLECTED	SAMPLE TYPE GRAB	COMP	MATRIX TYPE DW	BOTTLE COUNT 1	PRES CODE CLIENT PREPARED G	MATRIX TYPES: WW-WASTEWATER DW-DRAINAGE WATER GW-GROUND WATER WWEL-SLUDGE MS-NON-AQUEOUS SOLID SLURRY OIL-OIL SO-SOL SOL-SOLID
3 CHEMICAL PRESERVATION CODES: 1-HCL 2-H2SO4 3-HNO3 4-NAOH 5-NA2S2O3 6-UNPRESERVED 7-OTHER		DATE RESULTS NEEDED		DATE RESULTS NEEDED		DATE RESULTS NEEDED		DATE RESULTS NEEDED	
4 TURNAROUND TIME REQUESTED (PLEASE CIRCLE) (NORMAL RUSH) (RUSH TAT IS SUBJECT TO PACE LABS APPROVAL AND SURCHARGE) RUSH RESULTS VIA (PLEASE CIRCLE) EMAIL PHONE		PHONE # IF DIFFERENT FROM ABOVE:		PHONE # IF DIFFERENT FROM ABOVE:		PHONE # IF DIFFERENT FROM ABOVE:		PHONE # IF DIFFERENT FROM ABOVE:	
5 RELINQUISHED BY: (SIGNATURE) [Signature]		DATE 7/24/23 TIME 1030am		RECEIVED BY: (SIGNATURE) [Signature]		RECEIVED BY: (SIGNATURE) [Signature]		RECEIVED BY: (SIGNATURE) [Signature]	
6 COMMENTS: (FOR LAB USE ONLY)		SAMPLE TEMPERATURE UPON RECEIPT TEMPERATURE GUN ID CHILL PROCESS STARTED PRIOR TO RECEIPT SAMPLE(S) RECEIVED ON ICE SAMPLE ACCEPTANCE NONCONFORMANT REPORT IS NEEDED DATE AND TIME TAKEN FROM SAMPLE BOTTLE		SAMPLE TEMPERATURE UPON RECEIPT TEMPERATURE GUN ID CHILL PROCESS STARTED PRIOR TO RECEIPT SAMPLE(S) RECEIVED ON ICE SAMPLE ACCEPTANCE NONCONFORMANT REPORT IS NEEDED DATE AND TIME TAKEN FROM SAMPLE BOTTLE		SAMPLE TEMPERATURE UPON RECEIPT TEMPERATURE GUN ID CHILL PROCESS STARTED PRIOR TO RECEIPT SAMPLE(S) RECEIVED ON ICE SAMPLE ACCEPTANCE NONCONFORMANT REPORT IS NEEDED DATE AND TIME TAKEN FROM SAMPLE BOTTLE		SAMPLE TEMPERATURE UPON RECEIPT TEMPERATURE GUN ID CHILL PROCESS STARTED PRIOR TO RECEIPT SAMPLE(S) RECEIVED ON ICE SAMPLE ACCEPTANCE NONCONFORMANT REPORT IS NEEDED DATE AND TIME TAKEN FROM SAMPLE BOTTLE	

CHAIN OF CUSTODY RECORD

SAMPLE COLLECTED IN THE STATE OF MO

REGULATORY PROGRAM (CIRCLE):	NPDES
MORBCA	RCRA
CCDD	TACO: RES OR IND/COMM

PACE ANALYTICAL SERVICES
WWW.PACELABS.COM

ALL HIGHLIGHTED AREAS MUST BE COMPLETED BY CLIENT (PLEASE PRINT)

1 CLIENT	Terracon Consultants	PROJECT NUMBER	35237660	PROJECT LOCATION	Zwettlen	PURCHASE ORDER #	(FOR LAB USE ONLY)
ADDRESS	4765 - W Junction	PHONE NUMBER	417-864-5100	E-MAIL	Mandy Carlsson@terracon.com	DATE SHIPPED	LOGGED BY: _____ CLIENT: _____ PROJECT: _____ PROJ. MGR.: _____ CUSTODY SEAL #: _____
CITY STATE ZIP	Springfield, MO 65802	SAMPLER (PLEASE PRINT)	Mandy Carlsson	MATRIX TYPES:	WW-WASTEWATER DW-DRINKING WATER LW-LEACHATE WWS-SLUDGE MAS-NON AQUEOUS SOLID LCH-LEACHATE SOL-SOL	REMARKS	
CONTACT PERSON	Mandy Carlsson	SAMPLER SIGNATURE	<i>[Signature]</i>	DATE COLLECTED	7/21/23	DATE	ANALYSIS REQUESTED Methylated 200.00
2 SAMPLE DESCRIPTION (UNIQUE DESCRIPTION AS IT WILL APPEAR ON THE ANALYTICAL REPORT)	EES-TI-WF-023	DATE	7/21/23	TIME COLLECTED		DATE	
EES-TI-S-024							
EES-L-S-025							
EMS-CRR-S-026							
EMS-CRR-S-027							
EMS-BRR-S-028							
EMS-BRR-S-029							
EHS-BUR-S-030							
EHS-CALR-S-031							
EHS-C5-S-032							
EHS-C5-S-033							
CHEMICAL PRESERVATION CODES: 1-HCL 2-H2SO4 3-HNO3 4-NAOH 5-NA2S2O3 6-UNPRESERVED 7-OTHER							
5 TURNAROUND TIME REQUESTED (PLEASE CIRCLE) (RUSH FEE SUBJECT TO PACE LABS APPROVAL AND SURCHARGE)	NORMAL		RUSH		DATE RESULTS NEEDED		I understand that by initialing this box I give the lab permission to proceed with analysis, even though it may not meet all sample conformance requirements as defined in the receiving facility's Sample Acceptance Policy and the data will be qualified. Qualified data may NOT be acceptable to report to all regulatory authorities.
RUSH RESULTS VIA (PLEASE CIRCLE) EMAIL PHONE	10-Days						
RELINQUISHED BY: (SIGNATURE)	DATE		RECEIVED BY: (SIGNATURE)		DATE		COMMENTS: (FOR LAB USE ONLY) SAMPLE TEMPERATURE UPON RECEIPT _____ °C TEMPERATURE GUN ID _____ CHILL PROCESS STARTED PRIOR TO RECEIPT _____ Y OR N SAMPLE(S) RECEIVED ON ICE _____ Y OR N SAMPLE ACCEPTANCE NONCONFORMANT REPORT IS NEEDED _____ Y OR N DATE AND TIME TAKEN FROM SAMPLE BOTTLE _____
RELINQUISHED BY: (SIGNATURE)	TIME		RECEIVED BY: (SIGNATURE)		TIME		
RELINQUISHED BY: (SIGNATURE)	DATE		RECEIVED BY: (SIGNATURE)		DATE		
RELINQUISHED BY: (SIGNATURE)	TIME		RECEIVED BY: (SIGNATURE)		TIME		
RELINQUISHED BY: (SIGNATURE)	DATE		RECEIVED BY: (SIGNATURE)		DATE		
RELINQUISHED BY: (SIGNATURE)	TIME		RECEIVED BY: (SIGNATURE)		TIME		

REGULATORY PROGRAM (CIRCLE):	NPDES
MORBCA	RCRA
CCDD	TACO: RES OR IND/COMM

ALL HIGHLIGHTED AREAS MUST BE COMPLETED BY CLIENT (PLEASE PRINT)

1 CLIENT TERRACON CONSULTANTS 4765 W Junction Springfield, MO 65802 CONTACT PERSON: Mandy Carlson		PROJECT LOCATION Everton E-MAIL: Mandy.Carlson@terracon.com		PURCHASE ORDER # 05237060 PHONE NUMBER: 417-264-5100		DATE SHIPPED 		ANALYSIS REQUESTED 		4 (FOR LAB USE ONLY) LOGIN # _____ LOGGED BY: _____ CLIENT: _____ PROJECT: _____ PROJ. MGR: _____ CUSTODY SEAL #: _____					
2 (UNIQUE DESCRIPTION AS IT WILL APPEAR ON THE ANALYTICAL REPORT) EHS-C-HS-034 EHS-AR-S-035 EHS-AR-S-036 EHS-MR-S-037 EHS-GR-R-S-038 EHS-GR-R-S-039 EHS-BR-R-S-040 EHS-SR-S-041 EHS-SR-S-042 EHS-SR-S-043 EHS-H-WF-044		DATE COLLECTED 7/21/23		TIME COLLECTED 		SAMPLE TYPE COMP		MATRIX TYPE DW		BOTTLE COUNT 1		PRES CODE CLIENT PROVIDED 6		REMARKS Method 800.2	
5 TURNAROUND TIME REQUESTED (PLEASE CIRCLE) (NORMAL RUSH) (RUSH THAT IS SUBJECT TO PACE LABS APPROVAL AND SURCHARGE) RUSH RESULTS VIA (PLEASE CIRCLE) EMAIL PHONE 40-Days															
6 I understand that by initiating this box I give the lab permission to proceed with analysis, even though it may not meet all sample conformance requirements as defined in the receiving facility's Sample Acceptance Policy and the data will be qualified. Qualified data may NOT be acceptable to report to all regulatory authorities. PROCEED WITH ANALYSIS AND QUALIFY RESULTS: (INITIALS) <u>MC</u>															
7 RELINQUISHED BY: (SIGNATURE) 		RECEIVED BY: (SIGNATURE) 		DATE 7/21/23		DATE 		8 COMMENTS: (FOR LAB USE ONLY) label rubbed off		TEMPERATURE UPON RECEIPT TEMPERATURE GUN ID _____ °C CHILL PROCESS STARTED PRIOR TO RECEIPT _____ Y OR N SAMPLE(S) RECEIVED ON ICE _____ Y OR N SAMPLE ACCEPTANCE NONCONFORMANT REPORT IS NEEDED _____ Y OR N DATE AND TIME TAKEN FROM SAMPLE BOTTLE _____					



Pace Analytical Services, LLC
2231 W. Altorfer Drive
Peoria, IL 61615
(800)752-6651

October 06, 2023

Mandy Carlson
Terracon - Springfield MO
4765 Junction Street
Springfield, MO 65802

RE: B5237062 - EVERTON RESAMPLE

Dear Mandy Carlson:

Please find enclosed the analytical results for the 3 sample(s) the laboratory received on 8/9/23 3:30 pm and logged in under work order **GH01780**. All testing is performed according to our current TNI accreditations unless otherwise noted. This report cannot be reproduced, except in full, without the written permission of Pace Analytical Services, LLC.

If you have any questions regarding your report, please contact your project manager. Quality and timely data is of the utmost importance to us.

Pace Analytical Services appreciates the opportunity to provide you with analytical expertise. We are always trying to improve our customer service and we welcome you to contact the General Manager, Lisa Grant, with any feedback you have about your experience with our laboratory at 309-683-1764 or lisa.grant@pacelabs.com.

A handwritten signature in black ink, appearing to read "Chenise Lambert-Sykes".

Chenise Lambert-Sykes
Project Manager
(314)432-0550
Chenise.Lambert-Sykes@pacelabs.com



SAMPLE RECEIPT CHECK LIST

Items not applicable will be marked as in compliance

Work Order GH01780

YES	Samples received within temperature compliance when applicable
YES	COC present upon sample receipt
YES	COC completed & legible
YES	Sampler name & signature present
YES	Unique sample IDs assigned
YES	Sample collection location recorded
YES	Date & time collected recorded on COC
YES	Relinquished by client signature on COC
YES	COC & labels match
YES	Sample labels are legible
YES	Appropriate bottle(s) received
YES	Sufficient sample volume received
YES	Sample containers received undamaged
NO	Zero headspace, <6 mm present in VOA vials
NO	Trip blank(s) received
YES	All non-field analyses received within holding times
NO	Short hold time analysis
YES	Current PDC COC submitted
NO	Case narrative provided



ANALYTICAL RESULTS

Sample: GH01780-01
 Name: EHS-AR-S-036
 Matrix: Drinking Water - Regular Sample

Sampled: 08/04/23 10:32
 Received: 08/09/23 15:30

Parameter	Result	Unit	Qualifier	Prepared	Dilution	MRL	Analyzed	Analyst	Method
-----------	--------	------	-----------	----------	----------	-----	----------	---------	--------

Subcontracted Analysis - Pace Analytical - Ormond Beach

Lead	3.4	ug/L		08/04/23 10:32	1	1.0	10/04/23 19:12	PACE	EPA 200.8 REV 5.4
------	-----	------	--	----------------	---	-----	----------------	------	-------------------

Sample: GH01780-02
 Name: EHS-MR-S-037
 Matrix: Drinking Water - Regular Sample

Sampled: 08/04/23 10:31
 Received: 08/09/23 15:30

Parameter	Result	Unit	Qualifier	Prepared	Dilution	MRL	Analyzed	Analyst	Method
-----------	--------	------	-----------	----------	----------	-----	----------	---------	--------

Subcontracted Analysis - Pace Analytical - Ormond Beach

Lead	2.0	ug/L		08/04/23 10:31	1	1.0	10/04/23 19:13	PACE	EPA 200.8 REV 5.4
------	-----	------	--	----------------	---	-----	----------------	------	-------------------

Sample: GH01780-03
 Name: EPS-R-S-046
 Matrix: Drinking Water - Regular Sample

Sampled: 08/04/23 10:34
 Received: 08/09/23 15:30

Parameter	Result	Unit	Qualifier	Prepared	Dilution	MRL	Analyzed	Analyst	Method
-----------	--------	------	-----------	----------	----------	-----	----------	---------	--------

Subcontracted Analysis - Pace Analytical - Ormond Beach

Lead	3.6	ug/L		08/04/23 10:34	1	1.0	10/04/23 19:15	PACE	EPA 200.8 REV 5.4
------	-----	------	--	----------------	---	-----	----------------	------	-------------------



NOTES

Specifications regarding method revisions, method modifications, and calculations used for analysis are available upon request. Please contact your project manager.

* Not a TNI accredited analyte

Certifications

CHI - McHenry, IL - 4314-A W. Crystal Lake Road, McHenry, IL 60050

TNI Accreditation for Drinking Water and Wastewater Fields of Testing through IL EPA Accreditation No. 100279
Illinois Department of Public Health Bacterial Analysis in Drinking Water Approved Laboratory Registry No. 17556

PIA - Peoria, IL - 2231 W. Altorfer Drive, Peoria, IL 61615

TNI Accreditation for Drinking Water, Wastewater, Solid and Hazardous Material Fields of Testing through IL EPA Accreditation No. 100230

Illinois Department of Public Health Bacterial Analysis in Drinking Water Approved Laboratory Registry No. 17553

Drinking Water Certifications/Accreditations: Iowa (240); Kansas (E-10338); Missouri (870)

Wastewater Certifications/Accreditations: Arkansas (88-0677); Iowa (240); Kansas (E-10338)

Solid and Hazardous Material Certifications/Accreditations: Arkansas (88-0677); Iowa (240); Kansas (E-10338)

SPMO - Springfield, MO - 1805 W Sunset Street, Springfield, MO 65807

USEPA DMR-QA Program

STL - Hazelwood, MO - 944 Anglum Rd, Hazelwood, MO 63042

TNI Accreditation for Wastewater, Solid and Hazardous Material Fields of Testing through KS KDHE Certification No. E-10389

TNI Accreditation for Wastewater, Solid and Hazardous Material Fields of Testing through IL EPA Accreditation No. - 200080

Illinois Department of Public Health Bacterial Analysis in Drinking Water Approved Laboratory, Registry No. 171050

Missouri Department of Natural Resources - Certificate of Approval for Microbiological Laboratory Service - No. 1050



Certified by: Chenise Lambert-Sykes, Project Manager



October 05, 2023

Chenise Lambert-Sykes
Pace Analytical Services, Inc - IL/MO
944 Anglum Road
Hazelwood, MO 63042

RE: Project: GH01780
Pace Project No.: 35831277

Dear Chenise Lambert-Sykes:

Enclosed are the analytical results for sample(s) received by the laboratory on October 02, 2023. The results relate only to the samples included in this report. Results reported herein conform to the applicable TNI/NELAC Standards and the laboratory's Quality Manual, where applicable, unless otherwise noted in the body of the report.

The test results provided in this final report were generated by each of the following laboratories within the Pace Network:

- Pace Analytical Services - Ormond Beach

If you have any questions concerning this report, please feel free to contact me.

Sincerely,

Brad Smith
brad.smith@pacelabs.com
(386) 672-5668
Project Manager

Enclosures



REPORT OF LABORATORY ANALYSIS

This report shall not be reproduced, except in full,
without the written consent of Pace Analytical Services, LLC.



CERTIFICATIONS

Project: GH01780
Pace Project No.: 35831277

Pace Analytical Services Ormond Beach

8 East Tower Circle, Ormond Beach, FL 32174
Alaska DEC- CS/UST/LUST
Alabama Certification #: 41320
Colorado Certification: FL NELAC Reciprocity
Connecticut Certification #: PH-0216
Delaware Certification: FL NELAC Reciprocity
DoD-ANAB #: ADE-3199
Florida Certification #: E83079
Georgia Certification #: 955
Guam Certification: FL NELAC Reciprocity
Hawaii Certification: FL NELAC Reciprocity
Illinois Certification #: 200068
Indiana Certification: FL NELAC Reciprocity
Kansas Certification #: E-10383
Kentucky Certification #: 90050
Louisiana Certification #: FL NELAC Reciprocity
Louisiana Environmental Certificate #: 05007
Maine Certification #: FL01264
Maryland Certification: #346
Massachusetts Certification #: M-FL1264
Michigan Certification #: 9911
Mississippi Certification: FL NELAC Reciprocity

Missouri Certification #: 236
Montana Certification #: Cert 0074
Nebraska Certification: NE-OS-28-14
New Hampshire Certification #: 2958
New Jersey Certification #: FL022
New York Certification #: 11608
North Carolina Environmental Certificate #: 667
North Carolina Certification #: 12710
North Dakota Certification #: R-216
Ohio DEP 87780
Oklahoma Certification #: D9947
Pennsylvania Certification #: 68-00547
Puerto Rico Certification #: FL01264
South Carolina Certification: #96042001
Tennessee Certification #: TN02974
Texas Certification: FL NELAC Reciprocity
US Virgin Islands Certification: FL NELAC Reciprocity
Virginia Environmental Certification #: 460165
West Virginia Certification #: 9962C
Wisconsin Certification #: 399079670
Wyoming (EPA Region 8): FL NELAC Reciprocity

REPORT OF LABORATORY ANALYSIS

This report shall not be reproduced, except in full,
without the written consent of Pace Analytical Services, LLC.



SAMPLE ANALYTE COUNT

Project: GH01780
Pace Project No.: 35831277

Lab ID	Sample ID	Method	Analysts	Analytes Reported	Laboratory
35831277001	GH01780-01	EPA 200.8	LEC	1	PASI-O
35831277002	GH01780-02	EPA 200.8	LEC	1	PASI-O
35831277003	GH01780-03	EPA 200.8	LEC	1	PASI-O

PASI-O = Pace Analytical Services - Ormond Beach

REPORT OF LABORATORY ANALYSIS

This report shall not be reproduced, except in full,
without the written consent of Pace Analytical Services, LLC.



ANALYTICAL RESULTS

Project: GH01780
 Pace Project No.: 35831277

Parameters	Results	Units	Report Limit	DF	Prepared	Analyzed	CAS No.	Qual
Sample: GH01780-01								
Lab ID: 35831277001 Collected: 08/04/23 10:32 Received: 10/02/23 10:35 Matrix: Drinking Water								
Analytical Method: EPA 200.8								
Pace Analytical Services - Ormond Beach								
200.8 MET ICPMS Drinking Water								
Lead	3.4	ug/L	1.0	1		10/04/23 19:12	7439-92-1	

REPORT OF LABORATORY ANALYSIS

This report shall not be reproduced, except in full,
 without the written consent of Pace Analytical Services, LLC.